

Rotary cam switches  
**BSW 813-495-X64-06L3**  
**Order Code: BSW0051**

**BALLUFF**

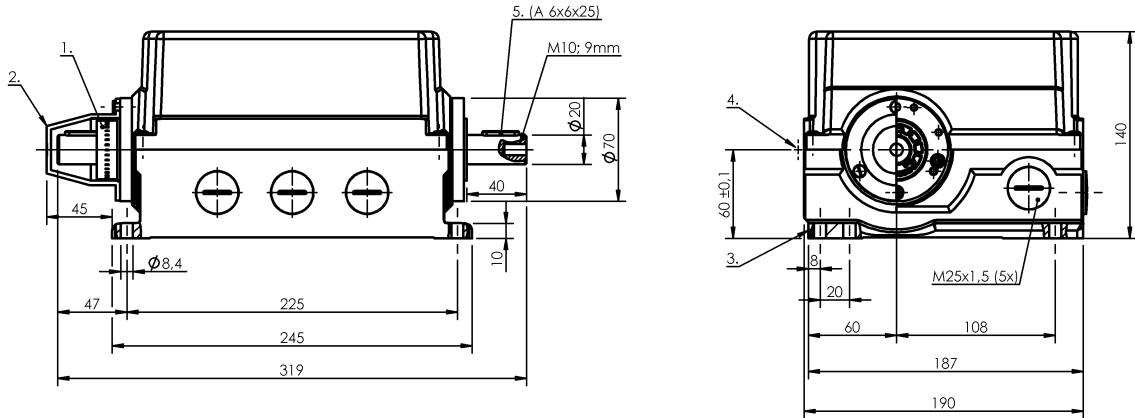

1) Scale ring, 2) Cover, 3) Reference edge, 4) Hinge, 5) Feather key



**Basic features**

Approval/Conformity	CE UKCA CCC WEEE
Basic standard	IEC 60947-5-1
Operating principle	1. Switch position: Mechanical
Version	Safety EN 60204-1

**Electrical connection**

Connection type	1. Switch position: Cable fitting via threaded insert
-----------------	---

**Electrical data**

Cable entries, number	4 threaded exit M25
Continuous current	1-6. Switch position: 6 A
Rated operating voltage Ue	1-6. Switch position: 250 V AC
Speed max.	160 1/min
Speed monitor	None

**Environmental conditions**

Ambient temperature	-5...80 °C
IP rating	IP65

**Functional safety**

B10d (EN ISO 13849-1)	BSE 85: 1 mil. switching cycles
-----------------------	---------------------------------

**Material**

Housing material	Aluminium, Anodized
Housing material, surface protection	Anodized
Material contacts	1-6. Switch position: Fine silver

**Mechanical data**

Cam rings	1-6. Switch position: 180°
Cam rings can be secured	yes
Connection cross-section	1.5 mm <sup>2</sup>
Dimension	185 x 140 x 187 mm
Drive shaft, length	40.00 mm
Drive type	right
Life expectancy mechanical	1. Switch position: 1 mil. switching operations
Minimum torque	1.0 Nm
Mounting hold spacing B	165.0 mm
Rotation direction monitoring	no
Switching element	1-6. Switch position: BSE 85

**Range/Distance**

Opening angle min.	15°
--------------------	-----

## Wiring Diagrams

